

# GLIDELINE

GW70 CASEMENT WINDOW





# SPECIFICATION



## SIGHTLINES

FRAME 70 MM, SASH 70 MM

## GLAZING

MAX. 44 MM, MIN. 23 MM

## MAXIMUM SASH DIMENSIONS

SLIM SASH (SIDE HUNG): WIDTH (L) 750 MM, HEIGHT (H) 1500 MM  
 SLIM SASH (TOP HUNG): WIDTH (L) 1200 MM, HEIGHT (H) 1500 MM  
 HEAVY DUTY SASH (SIDE HUNG): WIDTH (L) 950 MM, HEIGHT (H) 1750 MM  
 HEAVY DUTY SASH (TOP HUNG): WIDTH (L) 1800 MM, HEIGHT (H) 1800 MM

## MAXIMUM SASH WEIGHT

SIDE HUNG SLIM SASH: 35 KG  
 TOP HUNG SLIM SASH: 50 KG  
 SIDE HUNG HEAVY DUTY SASH: 42 KG  
 TOP HUNG HEAVY DUTY SASH: 100 KG

## COLOUR

POWDER COATING RAL FINISH  
 STANDARD 7016M, 9005M, 9016G  
 AVAILABLE IN 150+ RAL FINISHES  
 TEXTURED FINISH AVAILABLE  
 SPLIT COLOR FOR INTERIOR/EXTERIOR  
 WOOD EFFECT POWDER COATING  
 ANODIZED ALUMINIUM

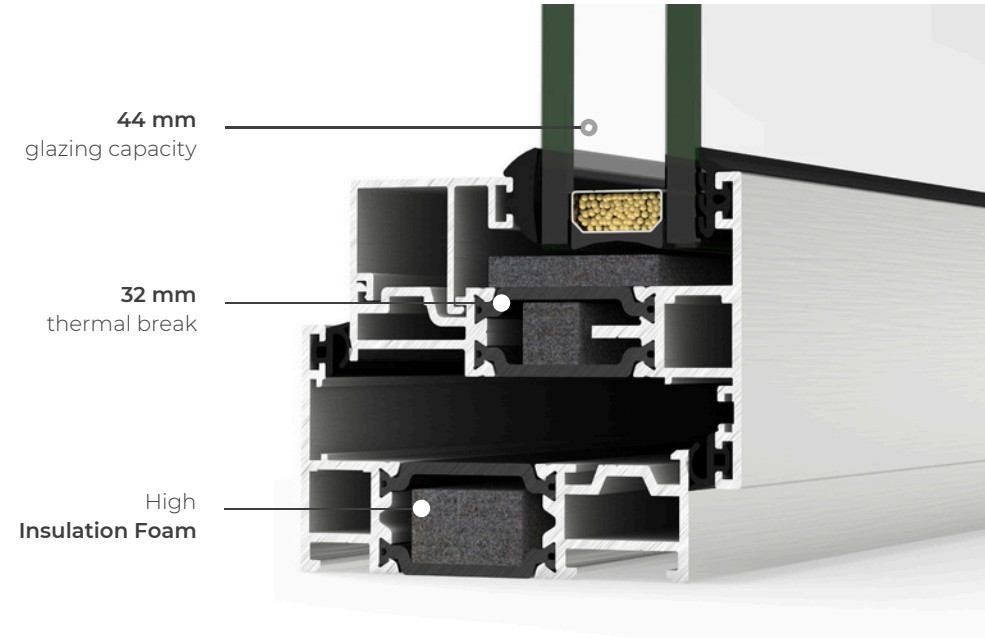

### BFRC Rating kWh/(m<sup>2</sup>.yr)

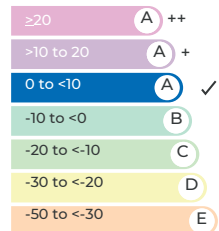

Double glazing

### BFRC Rating kWh/(m<sup>2</sup>.yr)

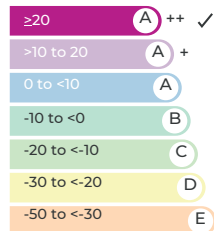

Triple glazing

## FEATURES

U value		Double glazing * Uw from 1.4 (W/m <sup>2</sup> K)	Triple glazing * Uw ≥ 1.0 (W/m <sup>2</sup> K)
Acoustic insulation		Rw up to 45 dB	
Air permeability		Class 4	
Water tightness		Class E1200	
Wind resistance		Class CE 2400	
Security test		PAS24 <input checked="" type="checkbox"/>	Passed

\* Double glazing Ug=1.0 / Triple glazing Ug=0.5  
 Security test: Reference test 1.438 x 1.33 m / 1 sash

# CONFIGURATIONS



## FLUSH VERSION

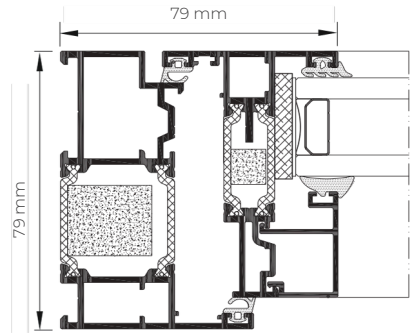

## STANDARD VERSION

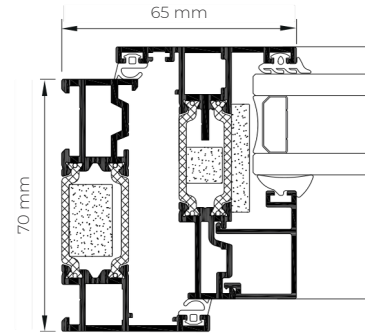

FLUSH  
VERSION



STANDARD  
VERSION

## DRAINAGE SUBCILLS

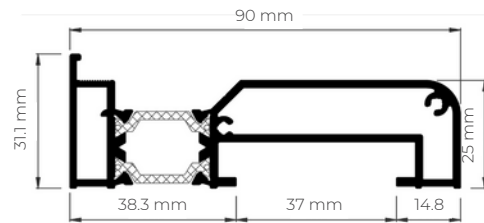

90 MM

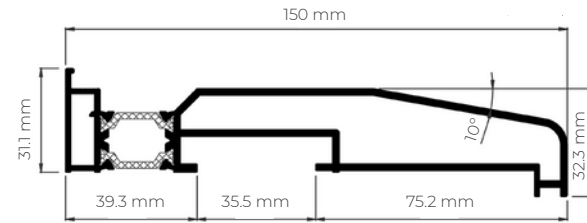

150 MM

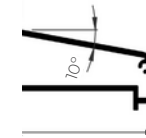

180 MM

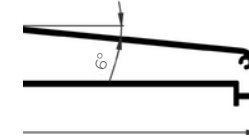

230 MM

## HEAD EXTENSION

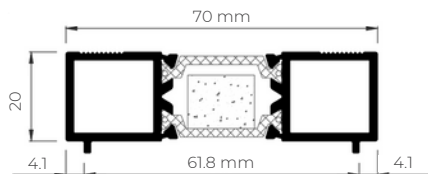

HEAD EXTENSION 20 MM

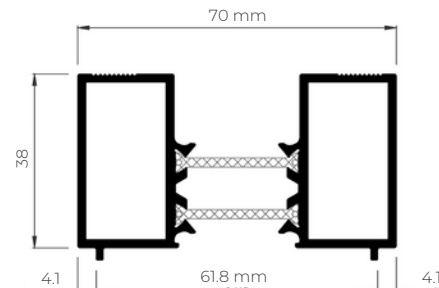

HEAD EXTENSION 38 MM

### OPENING POSSIBILITIES



Outward Opening  
Side hung  
Top hung

### POSSIBILITIES



SECURITY  
HARDWARE



CONCEALED  
HINGES

# HARDWARE



Regardless of whether you're looking to maintain modern aesthetics or a more traditional style, our choice of colours will suit you. We have a range of handle options to choose from to achieve the perfect look.

The aluminium casement windows that we supply at Glideline have been carefully designed to be thermally efficient. With a U-value of  $1.4 \text{ W/m}^2\text{K}$ , your or your customer's home will be comfortable all year round.





# GLIDELINE GO

KEEP UP TO DATE WITH YOUR  
GLAZING PROJECTS WITH  
GLIDELINE GO

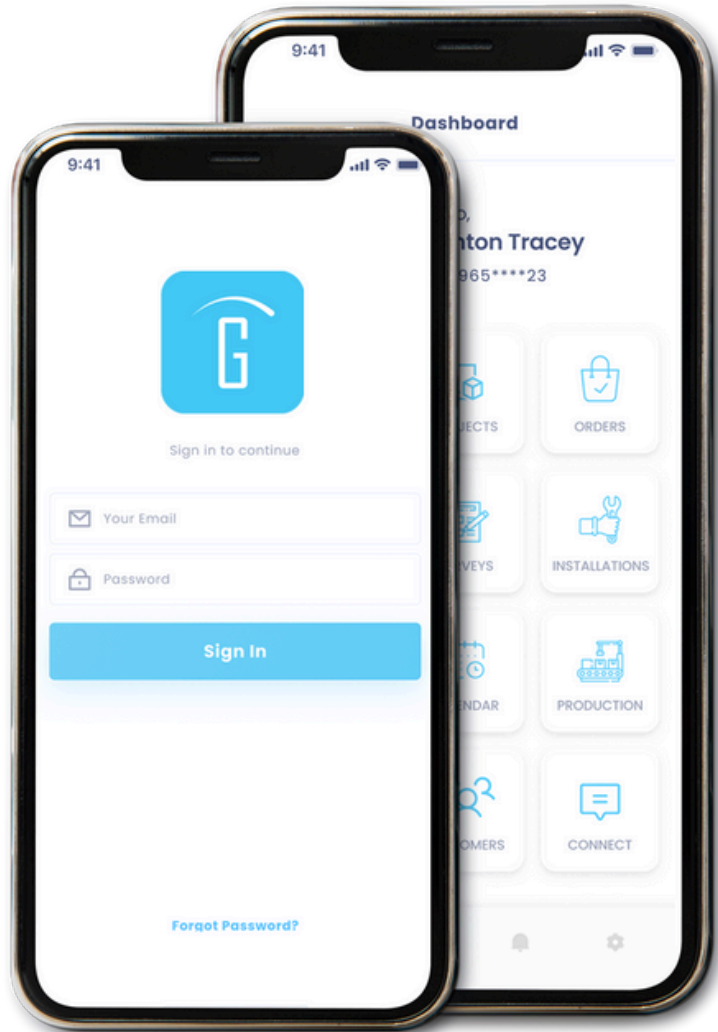

**Introducing GlidelineGO** – the ultimate system designed to streamline your glazing order management process. With GlidelineGO, customers and trade partners can effortlessly create, track, and manage orders, while enjoying the convenience of approving drawings and making payments directly within the app.

Efficiency and ease-of-use are at the heart of GlidelineGO. Whether you're an architect, contractor, or glazing professional, this powerful app empowers you to take control of your glazing projects, ensuring a seamless experience from start to finish.





# GLIDELINE